

SITE MAP LOCATION

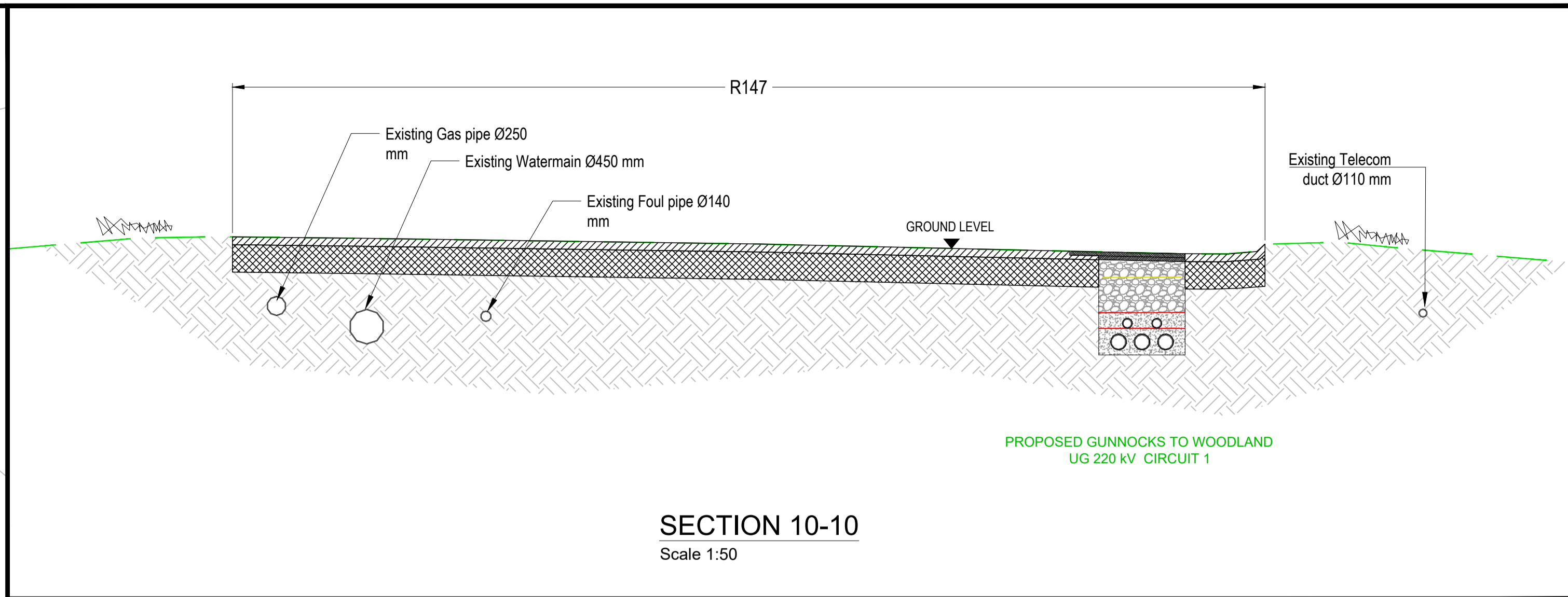

SECTION 10-10
Scale 1:50

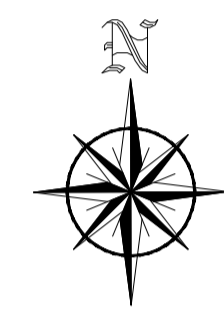
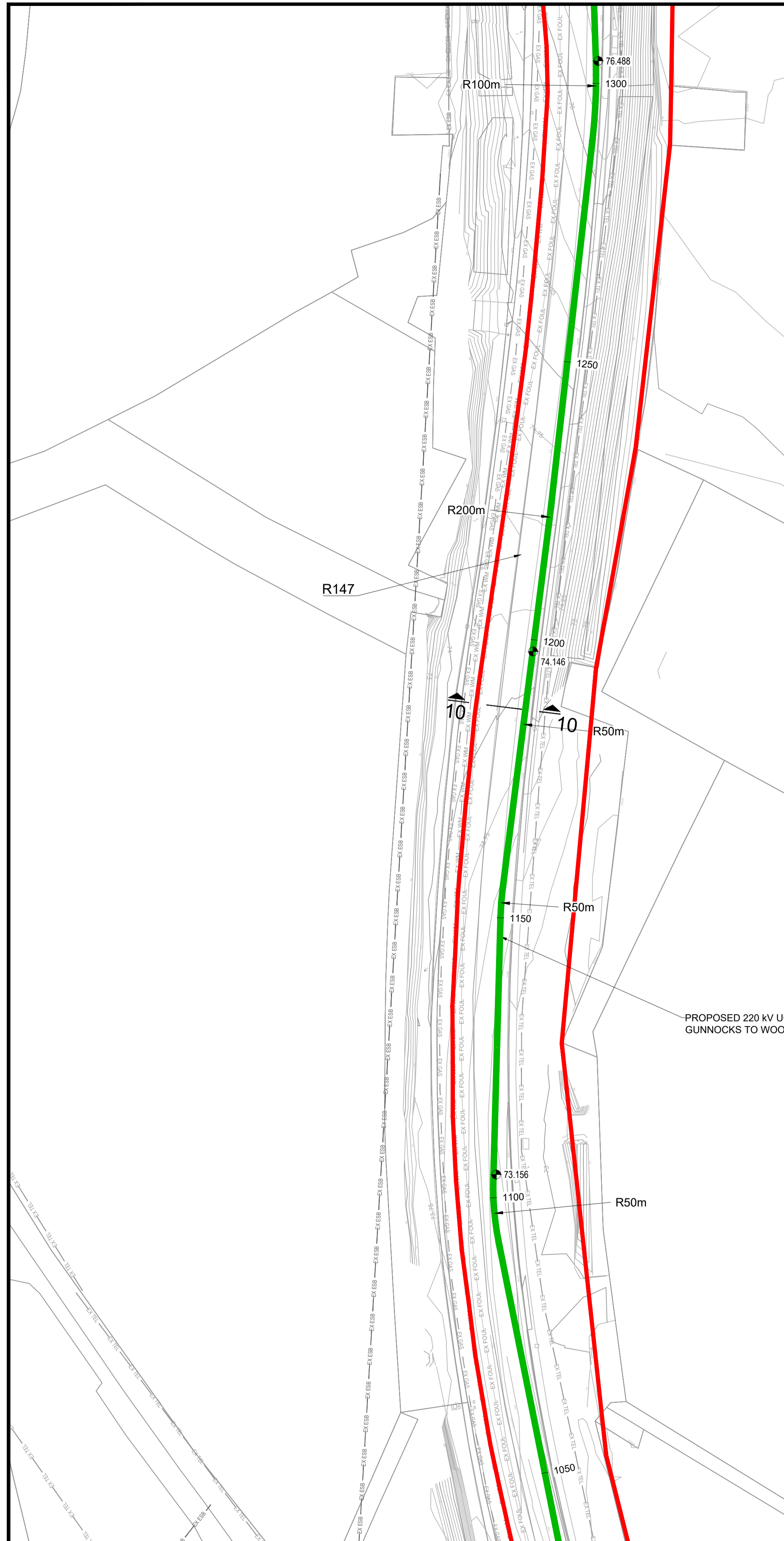

LEGEND:

APPLICATION SITE BOUNDARY	
LANDS IN APPLICANT'S CONTROL	
EXISTING RIGHT OF WAY / WAYLEAVE	
Proposed 4m Wide Access Path For Details Refer to Dwg. A1045-CSE-HEL-XX-DR-C-2031	
220 kV GRID ROUTE:	
PROPOSED 220 kV UG CIRCUIT 1 GUNNOCKS TO WOODLAND	
PROPOSED 220 kV UG CIRCUIT 2 GUNNOCKS TO CORDUFF	
PROPOSED 8m JOINT BAYS	
GROUND LEVEL	
EXISTING SERVICES	
EXISTING ESB	
EXISTING ESB OVERHEAD	
EXISTING GAS	
EXISTING TELECOMS	
EXISTING FOUL	
EXISTING WATERMAIN	

Rev	Description	Drawn	Checked	Date
P02	ISSUE FOR PLANNING	ZS	CD	30/07/2020
P01	DRAFT FOR PLANNING	ZS	CD	17/07/2020

Clifton Scannell Emerson Associates Limited
Consulting Engineers,
Salford Lodge,
Castledawson Avenue,
Blackrock, Co. Dublin,
Ireland, A94 P768
T. +353 1 288 5006
F. +353 1 283 3466
E. info@csea.ie
W. www.csea.ie

Client: **ENGINENODE**

Project: **ENGINENODE 220 KV SUBSTATION AND GRID CONNECTION**

Dwg. Title: **PROPOSED 220 KV ROUTE LAYOUT PLAN & SECTION SH 10 OF 13**

Drawn By: PH Date: 23-04-2020

Checked By: CD Scale: 1:500 @ A1

Project Code: A1045 - CSE - HEL - XX - DR - C - 2020

Status Code: S2 FOR INFORMATION

Revision: P02 PLANNING